

Site Address:
November Cottage Beech Lane Woodcote RG8 0PY
KC1031 81062632
100200045



CPH Contact:
Rochester Office

Date of works:
T.B.A

Drawn by: CW	Date drawn: 05/11/2020
-----------------	---------------------------

Drawing Requested By:
Emile Baldauf Clark

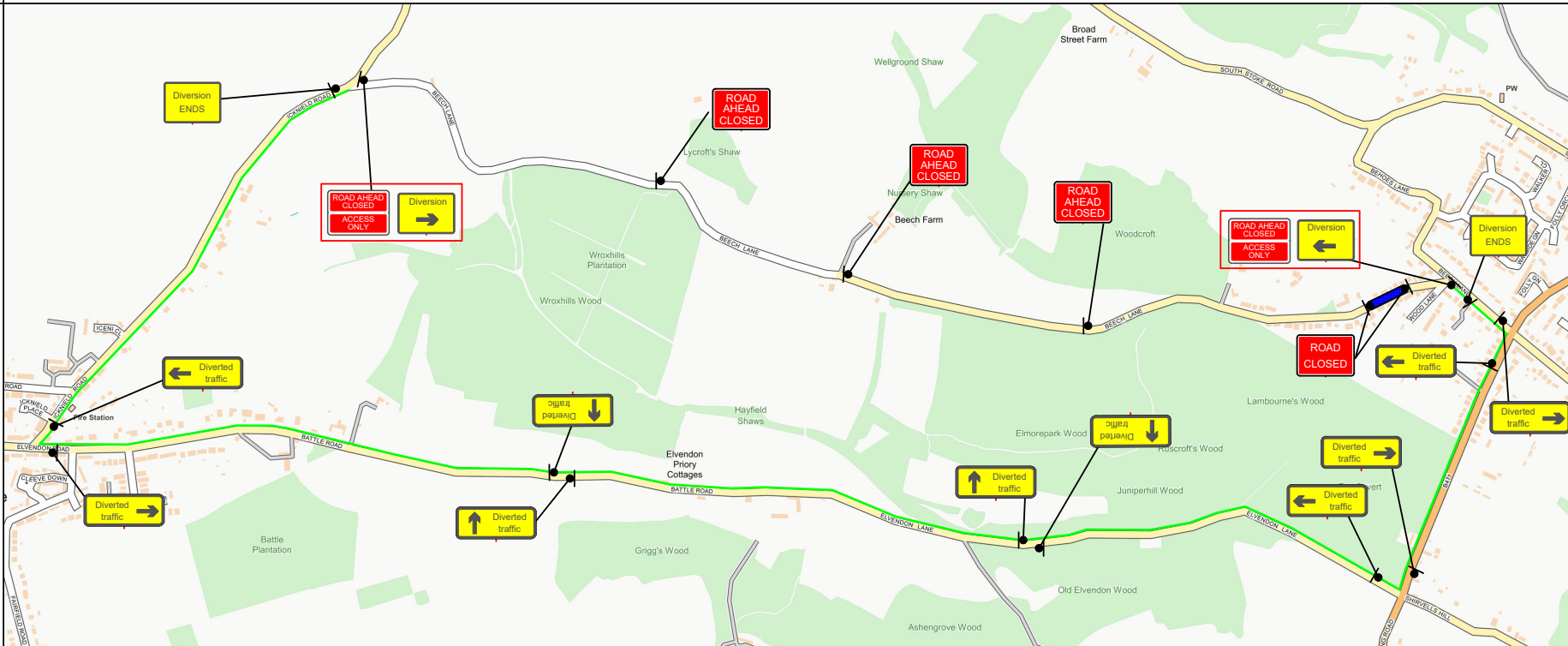

KEY

- Diversion Route
- 750 Road Cones
- Sign
- Temporary Pedestrian Crossing
- Temporary Traffic Signals
- Works Area
- Safety Zone
- Bus Stop To Be Suspended
- Stop & Go
- Van
- No Parking Cone
- Zebra Crossing
- Signalised Junction and or Push Button Crossing
- Pedestrian Barrier

NOTES

- 1) All temporary traffic management shall be in accordance with Chapter 8 Part 1 Design (2009); Part 2 Operations (2009); Part 3 Update (2020).
- 2) All temporary traffic management shall be in accordance with the Traffic Signs Regulations and General Directions 2016.
- 3) All temporary traffic management shall conform to the Safety at Streetworks and Road Works ACOP 2013.
- 4) All temporary traffic management signs should be located 450mm minimum from the kerb face.
- 5) All temporary traffic management sign locations are indicative and are subject to on site approval from the supervisor.

ROAD CLOSURE

SET-UP TO BE IN ACCORDANCE WITH THE NRSWA SAFETY AT STREET WORKS CODE



Clare House,
Coppermill Ln,
Harefield,
Middlesex, UB9 6HZ
Tel: 01895 823711
Email:
tmdrawings@theclancygroup.co.uk

Drawing Number:
CW/5140